

Dual Function Trailer Manual



ATTENTION:

Please read this instruction before mounting and using.

Disregarding the directions in this manual can cause damage or injury.

Model no. BT-1228SDU-S



Before you start assembly, please check the contents of the carton:

- ◆ 1 x trailer folded
- ◆ 1 x 8" front swivel wheel set
- ◆ 2 x 20" rear wheel
- ◆ 1 x handlebar
- ◆ 1 x tow bar
- ◆ 1 x quick release
- ◆ 2 x locking clip for rear wheel
- ◆ 2 x lock pin for handlebar
- ◆ 1 x flag

● Assemble the trailer(function 1)



Step 1:

When starting to assemble the trailer, push up the trailer from the back side.

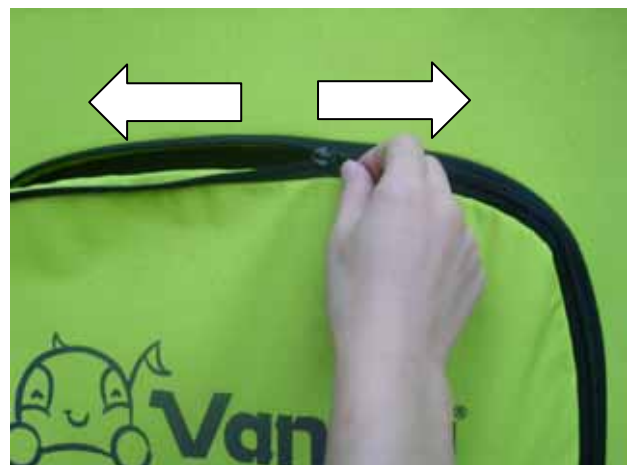

Step 2:

The folded mechanism is inside the rear pocket. Open the zipper first.



Step 3:

Pull the rear tubing backward. (The buckles might hit the seat back, push the seat back forwarder to let the buckles pass through it.)



Step 4:

Close the both side clips. The red lever will fall and set automatically.



Step 5:

Closed the zippers at both sides of fabric cover after both buckles are assembled to protect kids fingers.



Step 6:

The fabric cover should be kept closed during driving.



Step 7:

Insert the wheel axle into the wheel tube then insert the locking clip and make sure the wheels are locked into position.



Step 8 :

Insert the tow bar to the bracket at middle of front frame.



Step 9 :

Fasten the lever of the quick release and the tow bar is now secured.



Step 10:

Pull down the side protect bar at both sides of trailer.



Step11:

The ball pin at front side would be fell into bracket automatically.

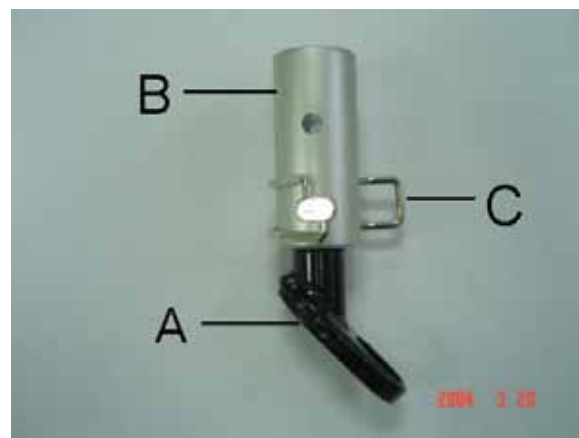

Step 12:

To assemble the trailer with your bike.

You have to examine that the hitch assembly is fixed at the end of tow bar.

A – black connector

B – silver alloy tubing

C – Locking clip



Step 13:

Use the wrench to release the nut of bike rear wheel axle. Remove the black connector (Part A) from the hitch assembly and slide the bike rear wheel axle through the hole of black connector. Then tighten the nut of bike rear wheel axle.



Step 14:

Take the silver alloy tubing (Part B) that fixed at the end of tow bar, insert the black connector into the silver alloy tubing. Rotate the black connector to align its hole with the hole of silver alloy tubing. Insert the locking clip into both holes to lock.



Step 15:

Circle the safety strap around the rear stay of bicycle and hook it back to the tow bar.



Step 16:

The entrance for child to come in and get out is the zipper door.



Step 17 :

When the child is in the trailer. The safe straps should harnessed and adjusted carefully.



Step 18 :

The transparent cover is made to protect the kids from rain and dust. Usually, the rain cover is rolled up. In case you need it, pull the transparent cover down and fasten the Velcro in the front of the canopy.



Step 19 :

Before using the trailer, put the flag into the mount at the left side. This is very important, because the trailer can be easy overlook in the traffic.



Step20:

When close (fold) the trailer, firstly open the zipper of the fabric cover, push up the red lever firstly. (It is the 2nd safety lock.) Then open the clip.



Step 21:

Push the rear tubing forward. Then the trailer could be folded.

● **Change the trailer to the baby stroller (function 2)**



Step 1 :

Insert the 8" front swivel wheel into bracket located at the front of the trailer. Use the quick release to tighten the stroller wheel.



Step 2:

When using the trailer as the stroller function, must assemble the handlebar. Insert the pins to the brackets of handlebar to finish assembly of the handle bar.

- **Parking device**-parking device should be engaged when placing and removing the children



Step 1 :

The brake system is at rear side. To set the parking brake, press the brake bar down into the locked position with your foot.



Step 2:

Make sure the brake shaft insert into the both side brake gears exactly.

- **Rear luggage** - The rear space could be used to stock the toys and small miscellaneous articles, maximum loading is 6kgs.



- **Instruction of safety belt.**

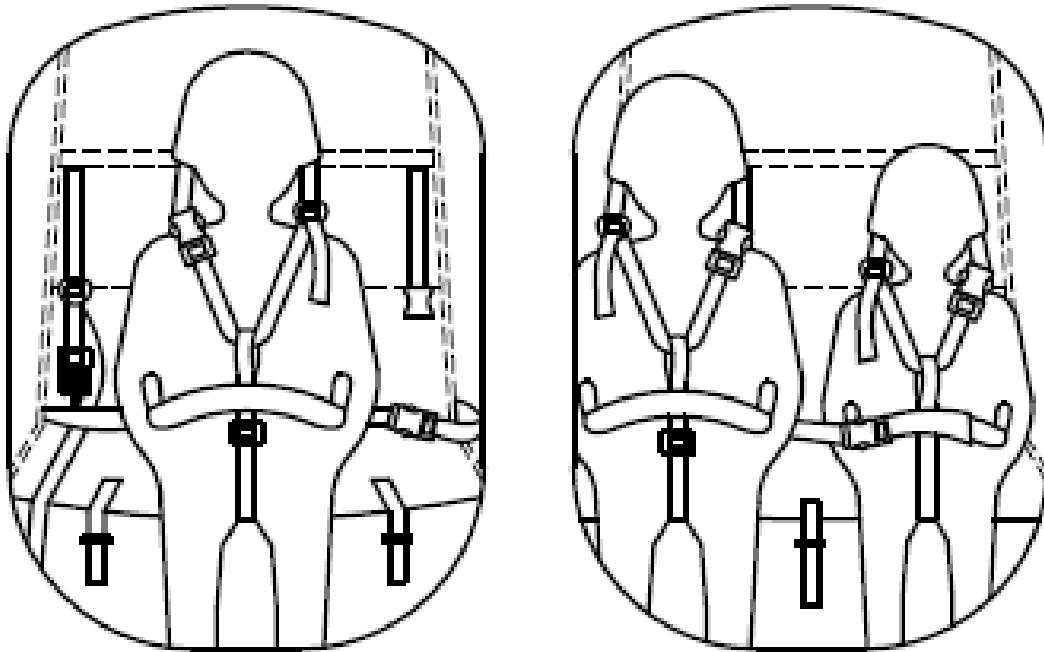

WARNING!

Always adjust the shoulder harness and crotch strap so that they meet at the child's lower chest. Adjusting harness and buckles near your child's neck could cause serious injury.

ONE CHILD

1. Unclip the right-hand shoulder harness from the 2nd safety lock buckle.
2. Seat child in the center of the seat.
3. Place center crotch strap between child's legs and adjust so that the strap loop is centered at the child's lower chest.
4. Thread the right-hand shoulder harness through the crotch strap loop, clip it into buckle over the child's right shoulder.
5. Fasten lap belt buckle and tighten snugly.

TWO CHILDREN

1. Unclip the shoulder harnesses from the 2nd safety lock buckles and unthread them.
2. Seat children in the trailer.
3. Place outer crotch straps between the children's legs and adjust so that the strap loops are centered at the children's lower chest.
4. Thread shoulder harnesses through the crotch strap loops, clip them into the buckles over the children's right shoulder and tighten by pulling the loose end from over the children's left shoulder.
5. Fasten lap belt buckle and tighten snugly.

SATETY NOTES/WARNING!:

1. This product is two functions, one is trailer function, the other is stroller function, when using as trailer, the front wheel must not be mounted at the trailer nor left into the trailer.
2. Maximum load = 42kgs(baby:18kgs+baby:18kgs+luggage:6kgs).
3. Maximum total weight: 58.6kgs
4. Minimum age of passengers: 9 months or could be seated without assistance.
5. Maximum height of passenger: 105cm or could be seated without assistance.
6. Maximum number of passengers: 2 children.
7. Maximum speed = 16km/h
8. Maximum pressure is 30-35 psi.
9. Maximum tow bar loading capacity:4kgs.
10. Minimum tow bar loading capacity: 0kgs
11. Never attach the trailer to the racing bike, off-road bike, e-bike or motor bike power assisted bike.
12. Never leave the kid unattended in the trailer.
13. The rider should be an adult in good physical condition, take more attention when driving downhill or around corners.
14. The person on the bike and the kid in the trailer should wear a helmet.
15. The safety belts should be adjusted carefully.
16. Please assemble the trailer exactly according this instruction.
17. Do not make any modifications to the trailer.
18. Do not park trailer near a ditch or dangerous road.
19. Don't put anything next to the child when it's sitting in the trailer as danger of injury.
20. Ensure that all the locking/packing devices are engaged and function well before use.
21. To avoid injury, ensure that your child is kept away when unfolding and folding this product.
22. Do not let your child play with this product.
23. Always use the restraint system.
24. Check the seat unit is correctly engaged before use.
25. This seat unit is not suitable for children under 6 months
26. The cover of a cycle trailer for children shall always be closed during the drive
27. When using as stroller function, it is not suitable for running or skating.
28. Parking device shall be engaged when placing and removing the children
29. Please note the braking distance of the cycle when the trailer is attached.
30. Any load attached to the handle and/or on the sides of the vehicle will affect the stability of the vehicle.
31. Accessories which are not approved by the manufacturer shall not be used
32. Only replacement parts supplied or recommended by the manufacturer/distributor shall be used.
33. Check tire pressure during assembly and before each ride, inspect routinely, maintain cleanly.

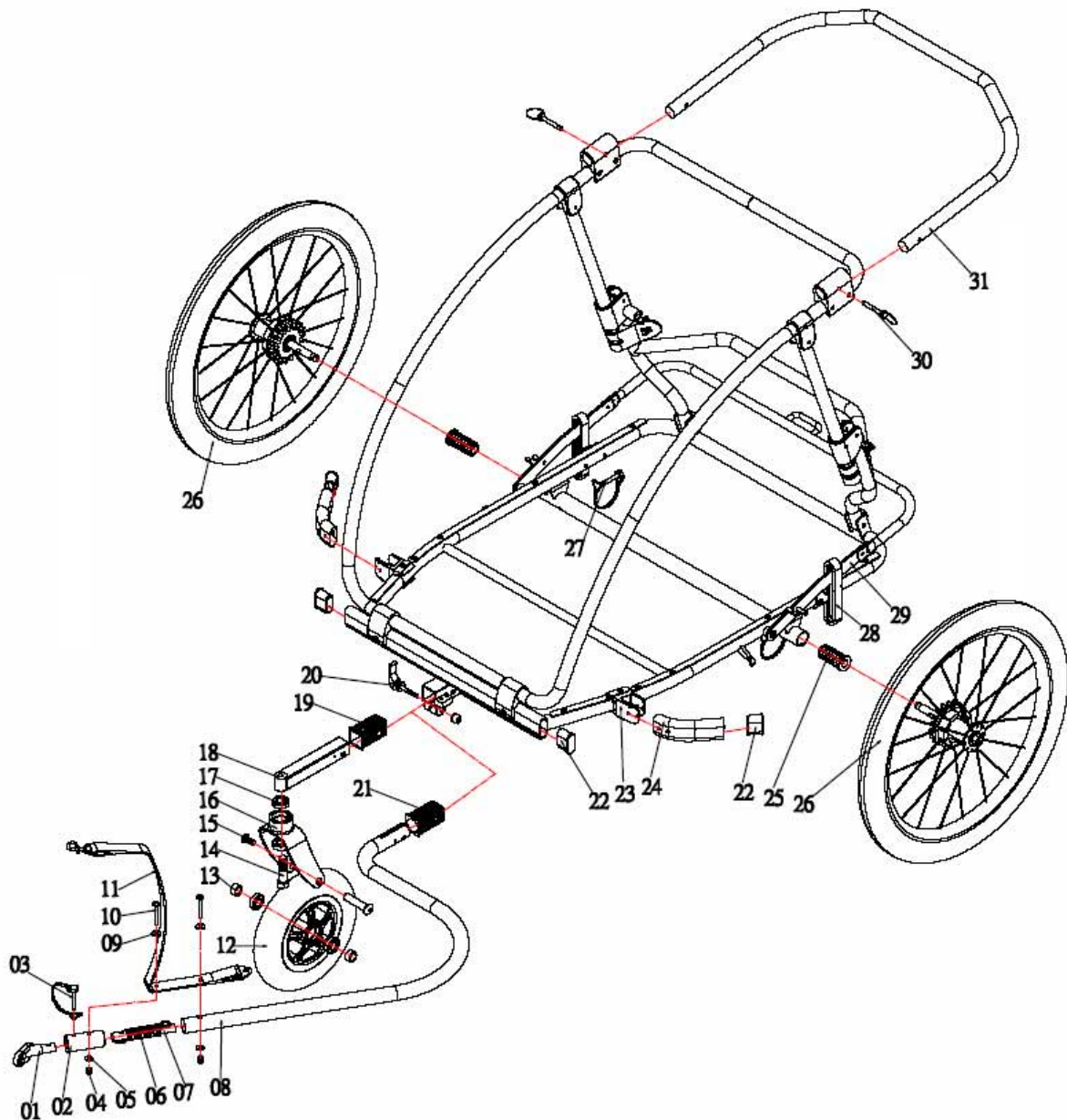

- | | | |
|----------------------------|--------------------------------|------------------------------|
| 1. Black connector | 13. Sleeve(2pcs)&bearing(2pcs) | 25. Rear wheel bushing(2pcs) |
| 2. Silver alloy tubing | 14. Screw bolt | 26. 20" Rear wheel(2pcs) |
| 3. Locking clip | 15. Front wheel axle | 27. Safety pin(2pcs) |
| 4. Nut (2pcs) | 16. Front fork | 28. Brake bracket(2pcs) |
| 5. Washer (2pcs) | 17. Ball bearing | 29. Park brake bar |
| 6. Yellow pipe | 18. Front wheel connection | 30. Ball pin (2pcs) |
| 7. Spring | 19. Front wheel housing | 31. Handle bar |
| 8. Tow bar | 20. Quick release | |
| 9. Washer(2pcs) | 21. Tow bar housing | |
| 10. Screw bolt (2pcs) | 22. End cap(4pcs) | |
| 11. Secondary safety strap | 23. Black plastic bracket | |
| 12. Front swivel wheel 8" | 24. Protection bar | |